

Adjustment of lying comfort:

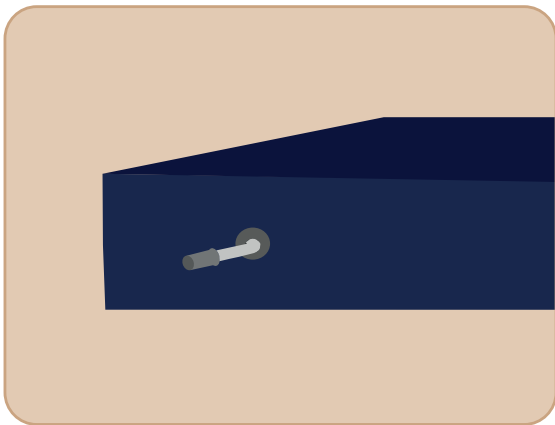

1. Put the mattress in the bed. Please note the imprint on top of the mattress „This side up“.

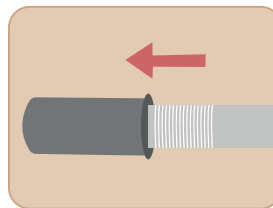

2. Open the valve by pulling and wait approx. 5 minutes, until the air-cells have inflated automatically.

The valve lock cannot fall off.

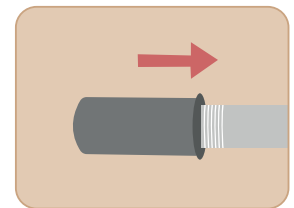

3. Close the valve by pressing.

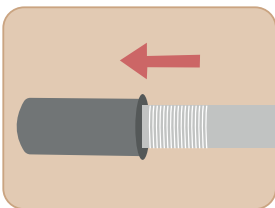

4. Place the patient on the mattress. Carefully open the valve by pulling the cap, so that air escapes and carry out a fingertest* at the same time.

**Place hand between buttocks and mattress. Optimal lying comfort is achieved when only a slight finger movement of 1 – 2,5 cm is possible.*

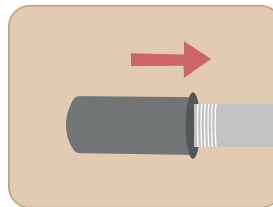

5. Close the valve by pressing.

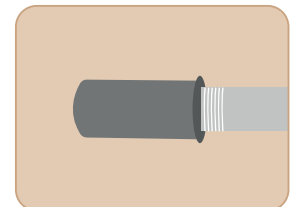

6. Daily checking of the correct filling of the air-cells is recommended. An adjustment may be necessary.