

## Adjustment of lying comfort:

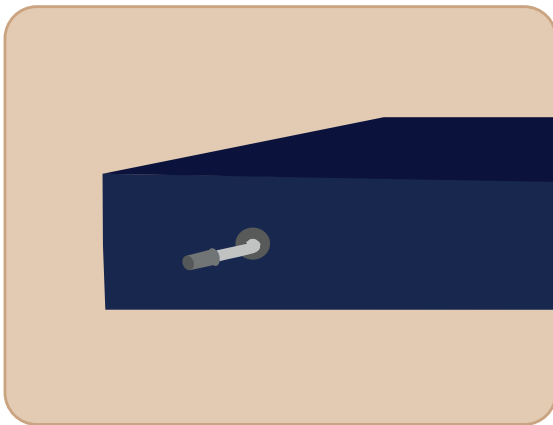

**1.** Put the mattress in the bed. Please note the imprint on top of the mattress „This side up“.

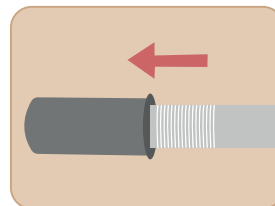

**2.** Open the valve by pulling and wait approx. 5 minutes, until the air-cells have inflated automatically.

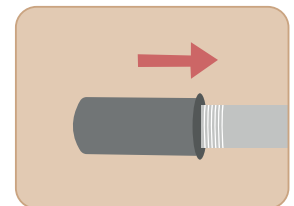

**3.** Close the valve by pressing.

*The valve lock cannot fall off.*

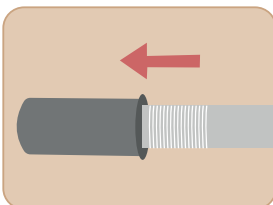

**4.** Place the patient on the mattress. Carefully open the valve by pulling the cap, so that air escapes and carry out a fingertest\* at the same time.

*\*Place hand between buttocks and mattress. Optimal lying comfort is achieved when only a slight finger movement of 1 – 2,5 cm is possible.*

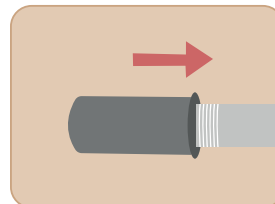

**5.** Close the valve by pressing.

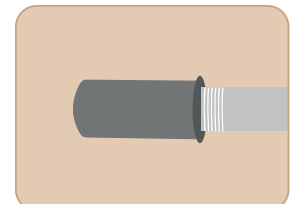

**6.** Daily checking of the correct filling of the air-cells is recommended. An adjustment may be necessary.

## Replacement of the air-cells:

If the air-cells are defective, the entire air-cell circuit must be replaced.  
Follow the steps to remove the air circuit correctly.

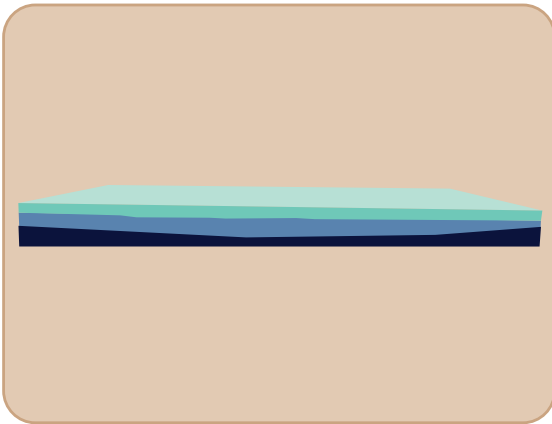

**1.** Open and remove the cover at the top of the mattress.



**2.** The top plate can be opened at the head end. Underneath is the air-cell circuit in a cover.

The valve is located on the left side at the head end of the mattress.

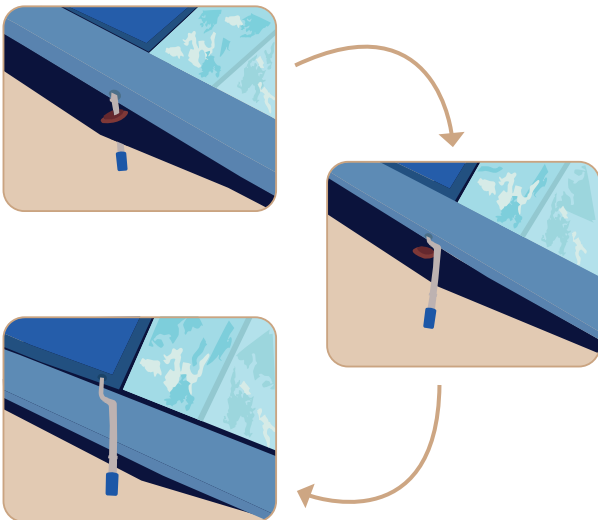

**3.** The valve must be carefully pushed through the cover and then through the foam.

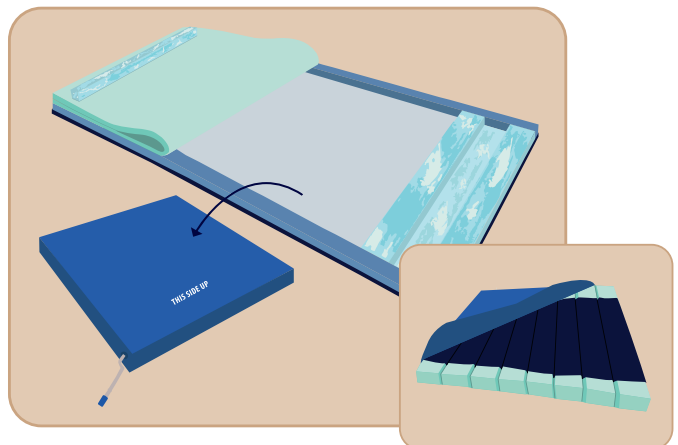

**4.** The air-cell circuit can now be removed from the mattress and be returned.

**5.** Once the new air-cell circuit has arrived, it must be replaced into the opened mattress. The print „This side up“ must face upwards.

The valve must be carefully pushed through the cover and then through the foam.

**6.** Close the top plate of the mattress. Then close the cover.

The mattress is now ready for use again.